



Liune



INSTALLATION INSTRUCTIONS | CORNER LIUNE

INSTALLATION



INSTALLATION

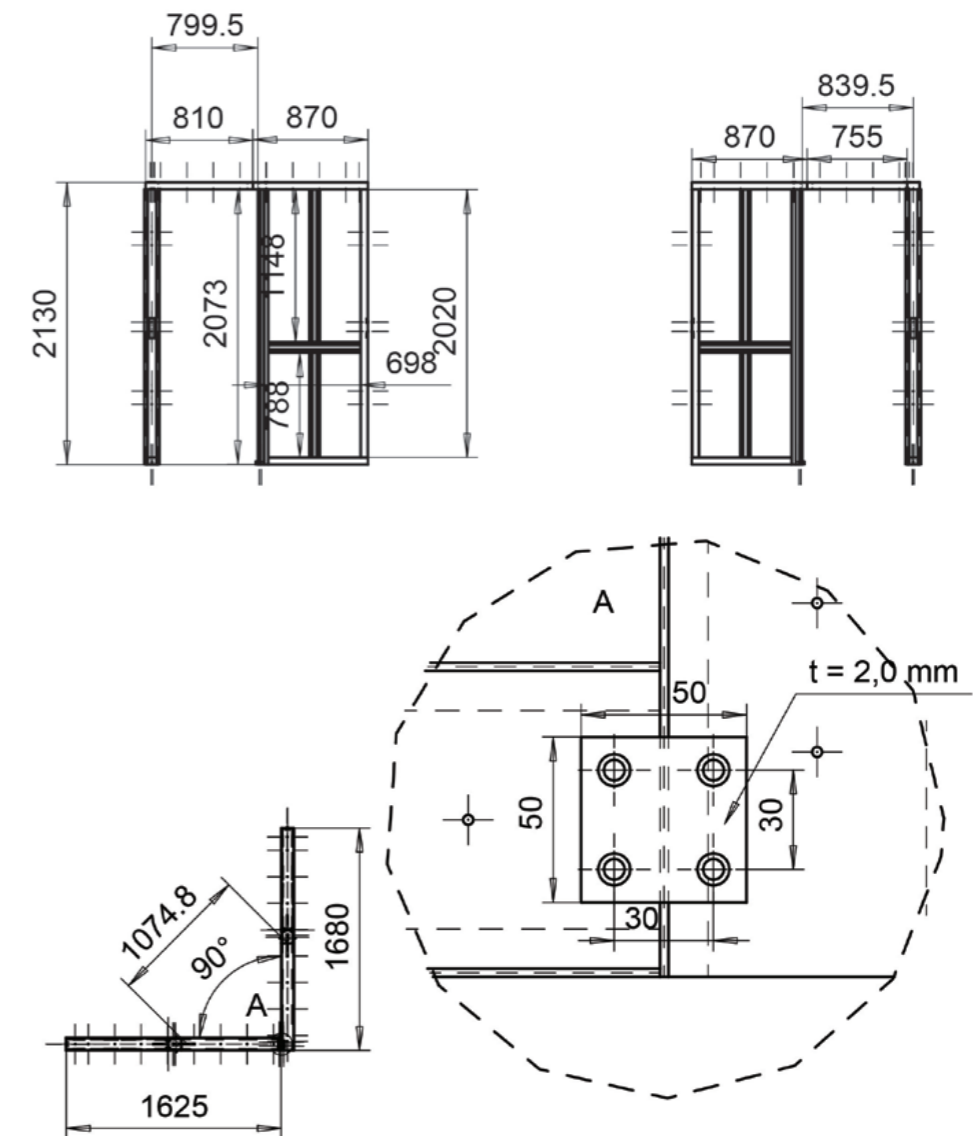

- 1 The corner Liune delivery contains 3 separate parts, which are 2 pocket elements and 1 corner piece.

The pocket elements are installed in the ready partition wall frame and attached to the wall frame from the sides, up and down (attaching from up is important for the door line not to bend down in the middle). The next step is to install the corner piece by attaching it to the pocket elements to unite them.

The corner piece is also attached to the wall structure to assure support from above. Check that the wall lines are straight and that the corner piece is straight (90 degree angle).

- 2 The pocket elements have marks to assure that the corner piece is attached correctly, follow the marks: 810 (element) = 810 (corner piece) and 755 (element) = 755 (corner piece). When this is done, continue the installation by following the instructions for double doors.



Liune Door Sales Office:
Aulis Lundell Oy
Tel. +358 207 341400
sales@liune.fi
www.liune.fi/en

**LIUNE
NORDIC
DESIGN**



EPD No. RTS_38_19
LIUNE -door system
with glass/MDF door
www.liune.fi/epd



Aulis Lundell Oy's production is certified by the ISO9001 –quality management system. The certification has been withheld since 2004.



Business environmentally certified since 2004.
Liune Door is patented No F17139 16.11.2005



TO BORROW THE PICTURES IN THIS INSTRUCTION MANUAL IS ALLOWED TO AULIS LUNDELL OY'S CUSTOMERS AND PARTNERS IF THE SOURCE IS MENTIONED. WE RESERVE THE RIGHT TO MAKE CHANGES TO THE PICTURES AND THE ACCOMPANING TEXTS.



www.liune.fi/en

